

Owners Manual

Stationary Kompensator[®] for FW8-77XX Series FW35-77XX Series FW7040-77XX Series

- Maintenance Procedures
- Comprehensive Warranty

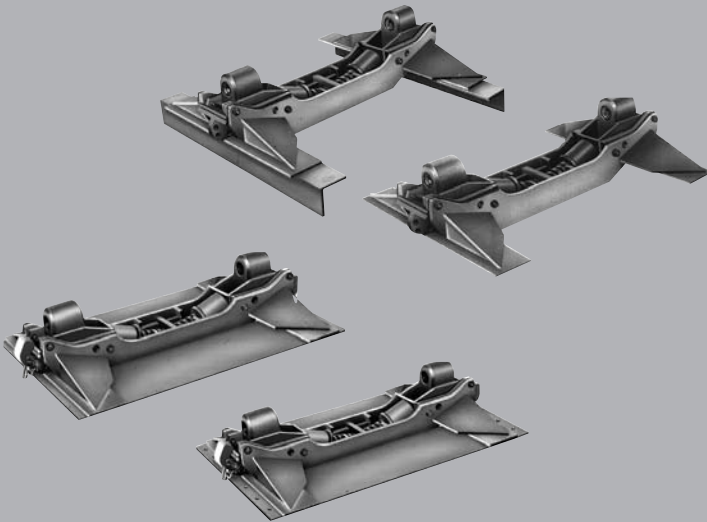

MAINTENANCE PROCEDURES

⚠WARNING Failure to read, understand, and follow the important information contained herein may result in a hazardous condition or cause a hazardous condition to develop.

All maintenance must be performed by a qualified person using proper tools and safe procedures.

All maintenance must be performed while the tractor is uncoupled from the trailer.

NOTE: The maintenance procedures contained in this manual apply mainly to the Kompensator® base subassembly portion of the fifth wheel assembly. Additional procedures beyond those discussed in this manual are required for the fifth wheel top plate. Contact your nearest Holland distributor for the appropriate additional information.

AS-NEEDED LUBRICATION

The following should be performed before putting into use and then **at least once per week or more frequently as required by operating conditions.**

Perform the following steps **while in the uncoupled condition** to allow correct application of lubricant.

While lifting up on the fifth wheel top plate, apply grease to the:

1. ...fittings on the fifth wheel top plate (see **Figure 1**), that supply grease to lubricate the bracket shoe cap and top plate pocket.
(NOTE: LowLube or NoLube top plates do not have these fittings.)
2. ...fittings on the side of the shoes (**Item 3**) that fill a reservoir that requires approximately 2 pounds of grease.
3. ...fittings on the base (ends) of the cradle (**Item 14**).
4. ...fittings on the front and back of the cradle (**Item 15**).

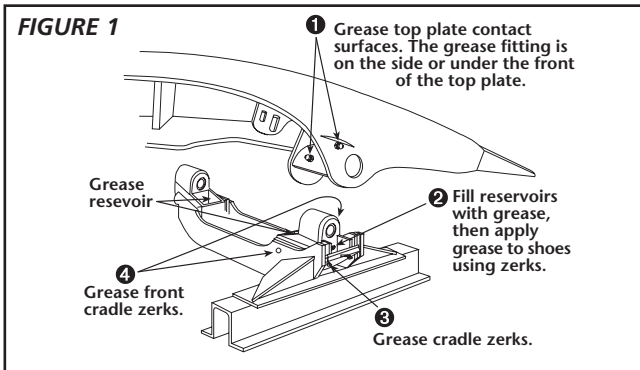

All of the following must be performed after the initial 5,000 miles of service and then every 60,000 miles or 6 months, whichever comes first. **Perform all inspections and adjustments after a thorough steam cleaning.**

NOTE: Severe service applications may require more frequent intervals.

1. Inspection – General

- A. Inspect the fifth wheel mounting. Check bolt torque and replace any loose, missing, or damaged bolts. Check for broken, distorted, or cracked components. Repair or replace as needed.
- B. Inspect fifth wheel top plate and Kompensator assembly for bent, worn, cracked, or broken parts. Replace with HOLLAND parts only (see **Figure 2**).

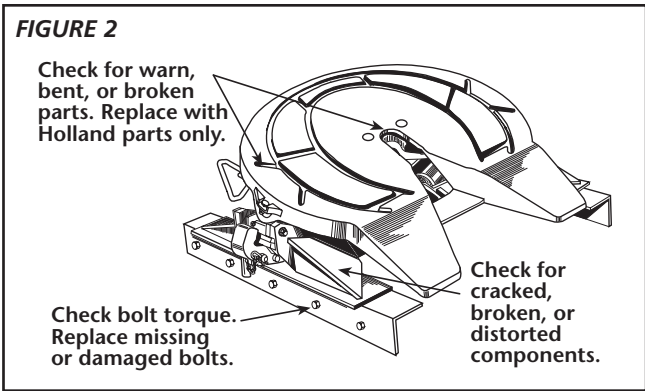

⚠ WARNING Do not use any fifth wheel which does not operate properly.

2. Fifth Wheel Locking Mechanism: Measure Fore-Aft Movement

- A. Test the operation of the fifth wheel locking mechanism using a Holland TF-TLN-5001, 2" Kingpin or TF-TLN-1500, 3-1/2" Kingpin Lock Tester. Inspect for proper locking.
- B. Check the adjustment of the fifth wheel locks by moving the lock tester fore and aft when locked in the locking mechanism. Fore and aft play should be adjusted to less than 0.06" (1/16"). Adjust the fifth wheel locks as described in Holland Publications "Fifth Wheel Owner's Manual" XL-FW483 Rev A or XL-FW489 Rev A for the particular type of locking mechanism. If the locks cannot be properly adjusted due to wear, the fifth wheel should be repaired or replaced. Your HOLLAND Distributor has parts, part kits and fifth wheel top plates available.

⚠ WARNING Improper adjustment can cause improper locking the mechanism.

- C. The trailer kingpin should also be inspected for wear and damage. A HOLLAND Kingpin Gauge (TF-0110) is available to aid this inspection.

3. Kompensator Base Sub-Assembly: Measure Fore-Aft Movement

- A. Measure the fore and aft movement of the shoe sub-assembly in the Kompensator bracket (see *Figure 3*).

Add shims (*ITEM 11*) and/or new bearing plates (*ITEM 12* or *ITEM 13*) when this movement exceeds 0.060" (1/16"). See *Figures 3* through *6*.

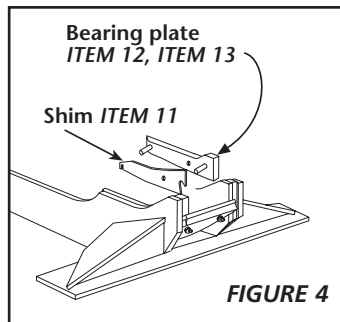
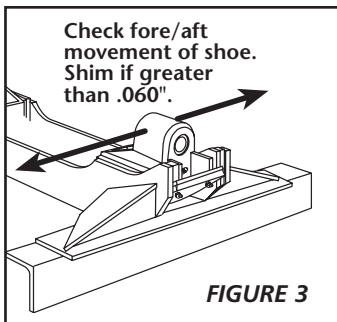

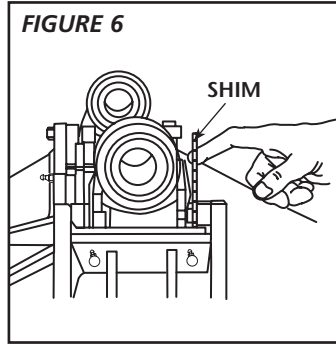
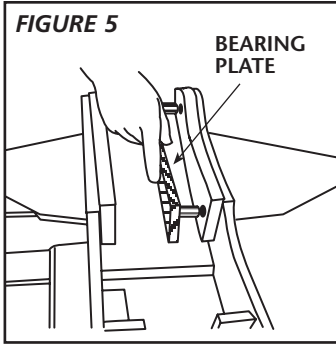

B. If shimming is required, shim as follows:

1. Remove shoes and disassemble Kompensator. See **Figure 3**.
2. Remove bearing plates (**ITEM 12** and **ITEM 13**). Measure thickness if less than .31" (5/16") thick. Replace with new Holland part.
3. Install shims.
4. Check for free lateral movement of shoe in frame. **DO NOT over shim.**

Recheck fore and aft movement of the shoe subassembly. Movement is to be less than .06" (1/16").

C. Inspect the cushions (**ITEM 5**) and other components for distortion and splitting or cracking. If disassembly is required, follow steps 1–5 under section 4 below, and replace as required.

4. Kompensator Base Subassembly: Measure Upward Movement

A. Measure upward clearance on the assembly. Do this on one side at a time by lifting the fifth wheel top plate upward manually with the aid of a bar (see **Figure 7**). Clamp the shoe (**ITEM 2**) on the opposite side to prevent its movement, which will affect the measurement (see **Figure 7**). If the total movement exceeds 0.5" (1/2"), the unit should be disassembled for further inspection.

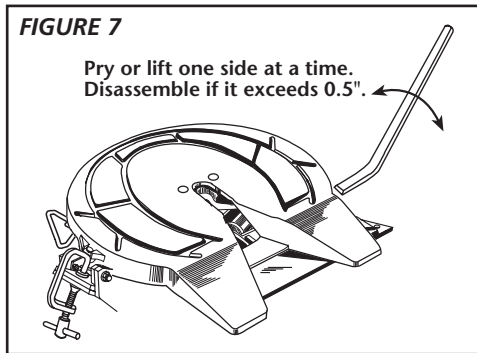

MAINTENANCE PROCEDURES *continued*

If disassembly is required, follow the steps below:

1. Remove the fifth wheel top plate from the Kompensator base removing the appropriate roll pins and bracket pins or cotter pins, nuts and bolts, depending upon model.
2. Remove all loose internal parts (shoes, tie rod, etc.).
3. Inspect all parts for distortion, wear and cracking. Replace if necessary.
4. Measure the thickness of the curved base of the shoe sub-assembly (**ITEM 2**). The shoe should be replaced if the base thickness measures less than 0.31" (5/16"). See **Figure 8**.
5. Reassemble and lubricate as noted above. Check for free lateral and fore-aft movement of the shoe sub-assemblies after reassembly.

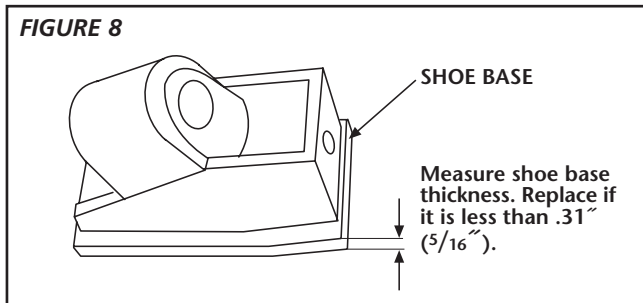

NOTE: For severe dusty/dirty environments, shoe dust covers (see **Figure 9**) are available. Request Holland parts XA-0128-L and XA-0128-R.

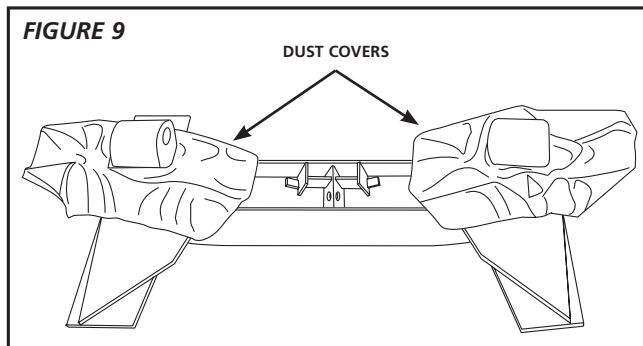

PARTS BREAKDOWN

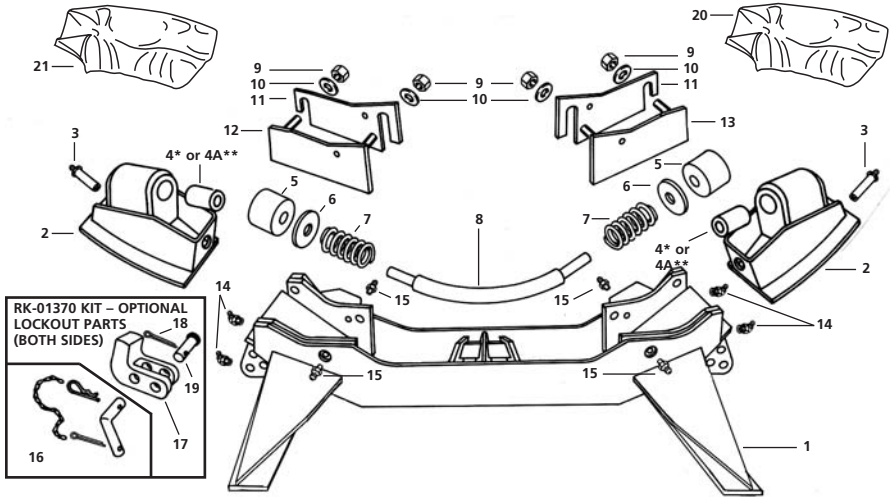

ITEM	PART NO.	NO.	PART NAME	ITEM	PART NO.	NO.	PART NAME
1	XA-45-77XX	1	Kompensator® Frame	11	XA-0014	2	Shim (as required)
2	XA-0024	2	Shoes Subassembly – includes part no. (3)	12	XA-01997	1	Bearing Plate – Right Hand
3	XB-H-38-F	2	Grease Fitting	13	XA-01998	1	Bearing Plate – Left Hand
4*	XB-0011	2	Rubber Cushion	14	XB-H-38-A	4	90° Grease Fitting
4A**	XB-0012	2	Rubber Cushion	15	XB-H-38	4	Grease Fitting
5	XB-0009	2	Cushion	16	XA-01429	2	"L" Pin Subassembly
6	XA-1284-2	2	Washer	17	XA-01427	2	Lockout Stop
7	XB-01923	2	Spring	18	XB-382	2	Cotter Pin .19" x 1.25"
8	XA-39	1	Tie Bar	19	XB-847	2	Shackle Pin
9	XB-C-59	4	Hex Nut 1/2"-13	20	XA-0128-L	1	Dust Cover (optional)
10	XB-T-45-1	4	Lock Washer 1/2"	21	XA-0128-R	1	Dust Cover (optional)

* Bushings used in conjunction with FW8, FW35, FW2040, FW3540 or FW3640 series fifth wheels.

** Bushings used in conjunction with FW7040 series fifth wheels.

RK-01370 KOMPENSATOR LOCKOUT KIT

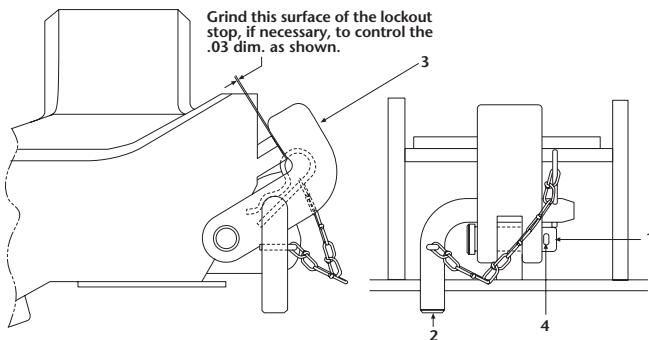

ITEM	PART NO.	NO.	PART NAME
1	XB-847	2	Shackle Pin
2	XA-01429	2	"L" Pin Sub-Assembly
3	XA-01427	2	Lockout Stop
4	XB-382	2	Cotter Pin

5-YEAR COMPREHENSIVE WARRANTY

Holland warrants all fifth wheel commercial products (other than those normally used for personal, family, or household purposes) manufactured after July 1, 1990, to be free from defects in material or workmanship for a period of 5 years from the date of manufacture, except elevating fifth wheels, which will carry a 180-day warranty. This warranty covers only defects in materials or workmanship and does not cover failures due to any of the following:

1. Normal wear
2. Improper installation
3. Intentional modification
4. Accident
5. Corrosion
6. Misuse
7. Failure to provide reasonable maintenance

This warranty does not guarantee a particular service life of the product since service life will vary with application, degree of use, operating environment, level of maintenance, and other factors beyond our control.

Holland's sole responsibility for any fifth wheel product or part determined by Holland to be defective and covered by this warranty is limited to repairing or replacing the product or part, and to providing an allowance to be applied to the labor cost of removal and replacement.

Prior authorization from Holland must be obtained before replacing or returning any part, or incurring any labor cost for removal. No charges for expense incurred in parts, labor, or transportation by unauthorized persons will be allowed under this warranty. Holland reserves the right to request the return of any part or fifth wheel assembly (with transportation charges prepaid) claimed to be covered by this warranty.

Holland shall not be liable, in any event, for proximate, incidental, consequential, special, or other damages, including — but not limited to — damages for loss of production, loss of profits, loss of opportunity, or injury to persons or property arising out of any breach of this warranty.

THERE ARE NO WARRANTIES, EXPRESS OR IMPLIED, INCLUDING THE WARRANTY OF MERCHANTABILITY, WARRANTY OF FITNESS FOR A PARTICULAR PURPOSE, OR ANY OTHER WARRANTY EXTENDING BEYOND THAT SET FORTH ABOVE.



IMPORTANT: Enclosed is important information for the installation, operation, and maintenance of this product. Read and understand this information.

! WARNING

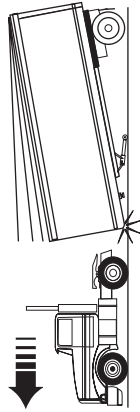

Failure to properly install, operate, or maintain this fifth wheel could result in tractor and trailer separation causing death or serious injury to others.



SAF-HOLLAND USA, Inc.
888.396.6501 Fax 800.356.3929

SAF-HOLLAND Canada Limited
519.537.3494 Fax 800.565.7753
Western Canada
604.574.7491 Fax 604.574.0244