



SERVICE ADVISORY

January 28, 1998

Page 1/3

FW8 (FLEETMASTER) INSPECTION & OUT-OF-SERVICE CONDITION

VERTICAL MOVEMENT BETWEEN TOP PLATE & BRACKET

- The function of the bracket pin and the rubber cushion is to retain the top plate to the bracket, and to absorb the shock load as the tractor is bob-tailing.

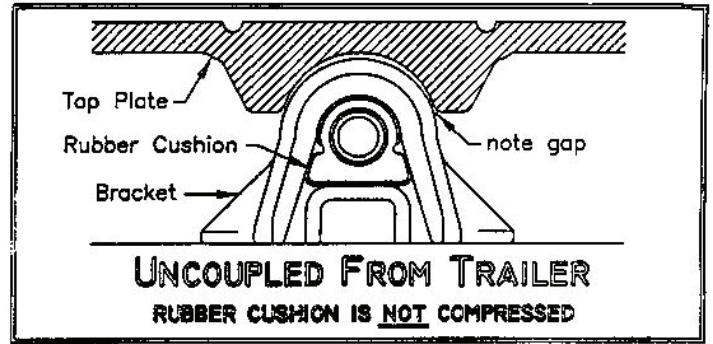
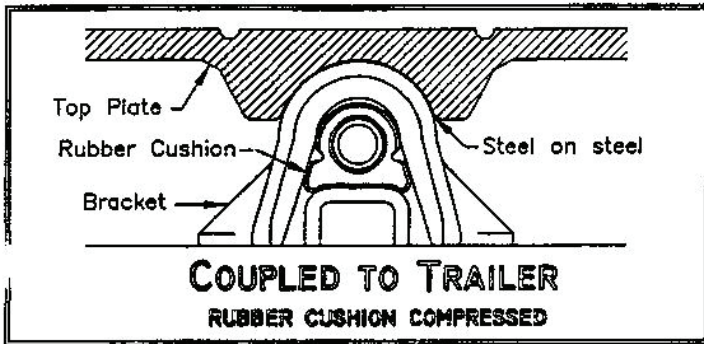

- When 3/8" [9.5 mm] free upward movement is detected, steel shims can be installed. These shims (XA-2018-4) are 3/16" [4.8 mm] thick, and are tack welded in the top plate casting. The shims will require grinding to achieve a proper fit to the bracket.

BRACKET PIN

- Holland Hitch XA-201 fifth wheel top plates have loose fitting bracket pins. When new there can be a difference of 0.025" [0.6 mm] between the diameters of the bracket pin and the hole in the fifth wheel top plate.

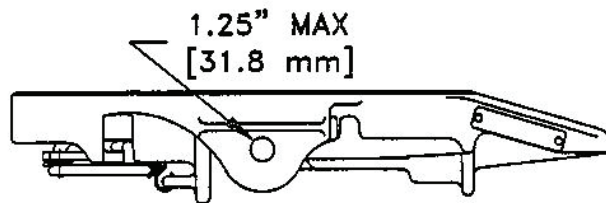

XA-201 SERIES TOP PLATE

BRACKET PIN OUT-OF-SERVICE CRITERIA

Holland's out-of-service condition is 1/8" [3.1 mm]. This measurement is the difference in the diameter of the hole in fifth wheel top plate and a new bracket pin.



SERVICE ADVISORY

January 28, 1998

Page 2/3

FW8 (FLEETMASTER) INSPECTION & OUT-OF-SERVICE CONDITION

LOCK JAW PIN HOLES

- The lock jaw pin in the XA-201 series top plate is a "loose" fit. When new the top plate may have 0.014 clearance between the lock jaw pin and the hole in the casting.

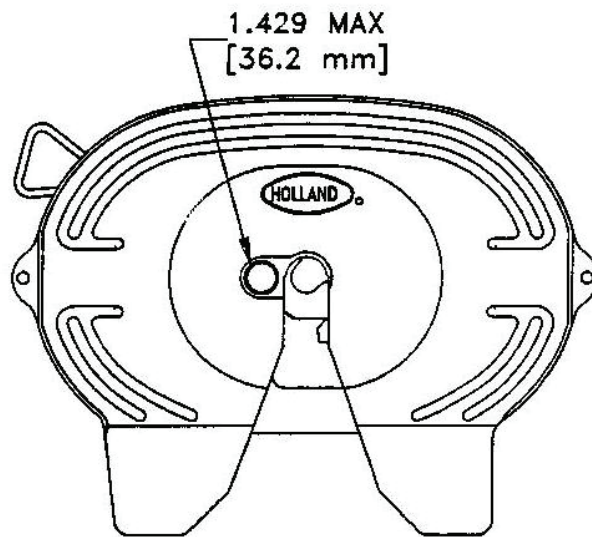

LOCK JAW PIN OUT-OF-SERVICE CRITERIA

Holland's out-of service condition is more than 0.045" [1.1 mm]. This measurement is the difference in the diameter of the hole in fifth wheel top plate and a new lock jaw pin.

HORIZONTAL MOVEMENT

- If the horizontal (fore and aft) movement between the fifth wheel locking mechanism and a Holland lock tester exceeds 1/4" [6.4 mm] the fifth wheel requires adjustment.

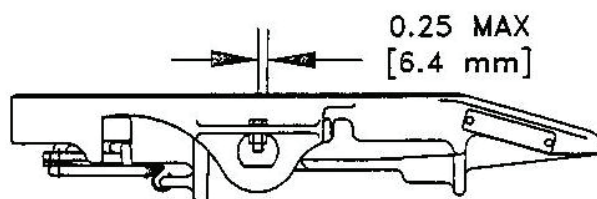



SERVICE ADVISORY

January 28, 1998

Page 3/3

FW8 (FLEETMASTER) INSPECTION & OUT-OF-SERVICE CONDITION

SLIDING BRACKETS

- When the horizontal fore and aft play in the sliding bracket mechanism exceeds $3/8$ " [9.5 mm] an adjustment is required.

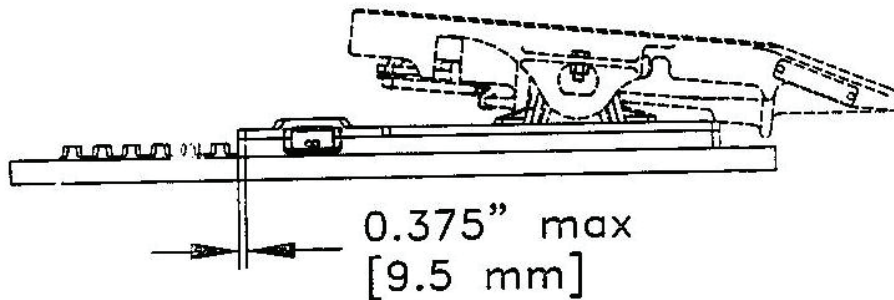

BRACKET OUT-OF-SERVICE CRITERIA

The out-of service condition is more than $3/8$ " [9.5 mm]. This $3/8$ " measurement can be either horizontal (fore and aft, left to right), or vertical (up and down).

